

PW-8899

Wireless headphone System

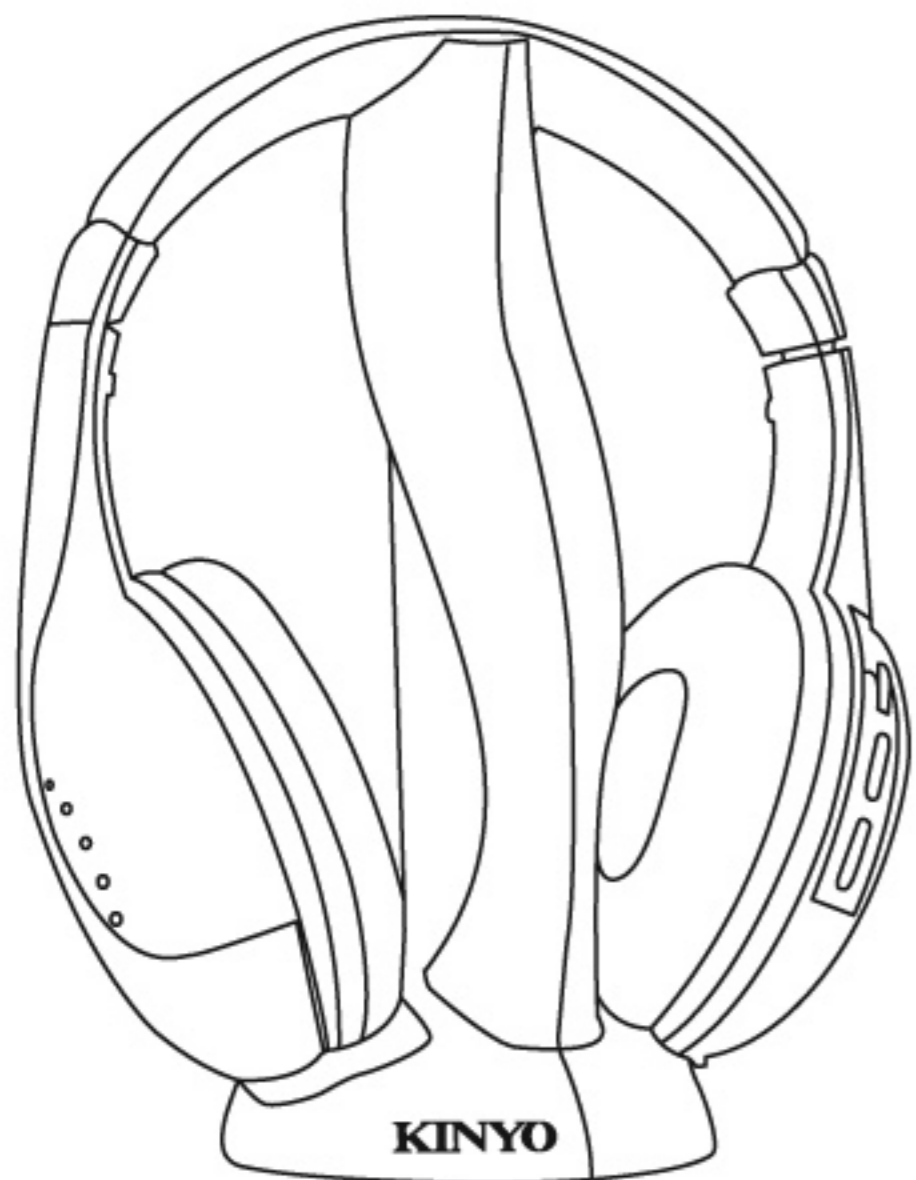

User's Manual

Please read and understand all safety instructions before use.

In the box



Wireless headphone



Wireless transmitter



User guide



Audio Cable
(Connect to any audio device with a 3.5mm audio connection such as iPod, iPhone, MP3 or CD Player. Cable also provides connectivity to the headphone for a wired option)



RCA Cable
(RCA cables allow for connection to your television)



AC Adaptor
(4.5V DC)

Location of controls

Receiver



Battery compartment
Volume/Power control
Scan key
Reset key
Power Indicator
Audio Socket

Transmitter

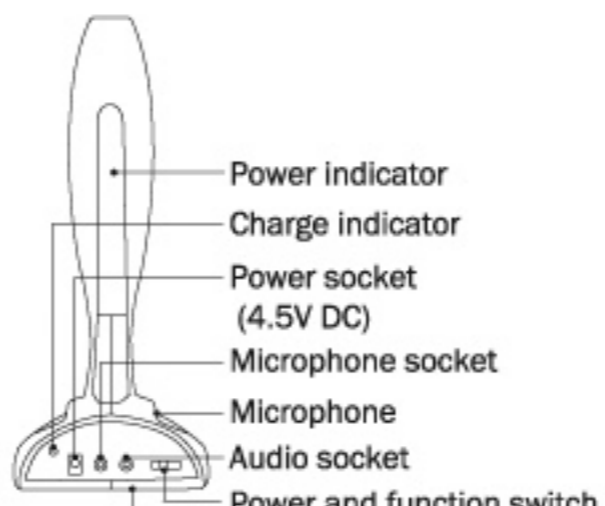

Power indicator
Charge indicator
Power socket (4.5V DC)
Microphone socket
Microphone
Audio socket
Power and function switch
Battery compartment cover

Wireless Connection

Wireless headphone (Fig. 1)

- Insert the transmitter audio cable into the AUDIO OUT socket of the electrical device or earphone socket and move the function switch of the transmitter to the wireless headphone position, and the power indicator of transmitter will go on.
- If in use with the television, it is advisable to mute the television for better audio experience.
- Turn on the volume/power on headphone, the power indicator of headphone will go on. First press the RESET key and press SCAN key, the sound sent from the transmitter should be sent

Wireless net audio chat (Fig. 2)

- Connect the transmitter audio cable to the adaptor cable, and insert the other end of the adaptor cable into the audio out socket of the PC, then insert one end of the audio cable into the microphone socket on the transmitter, and insert the other end into the microphone in socket of the PC.

Wireless monitoring (Fig. 3)

- Place the transmitter near the person you want monitored and aim the microphone towards the person.
- Move the function switch of the transmitter to the monitor position, and the power indicator will go on. Turn on the volume control and power button of the receiver, and the power indicator of the receiver will go on.
- Press the RESET key, and press the SCAN key, the sound sent out from transmitter can be heard with the headphone.

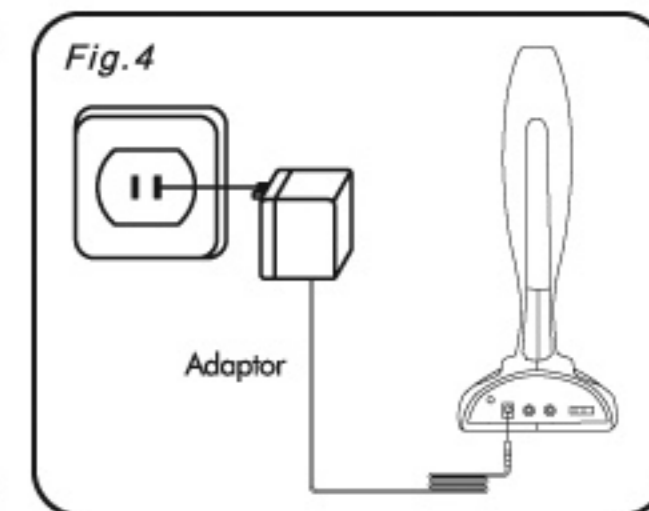
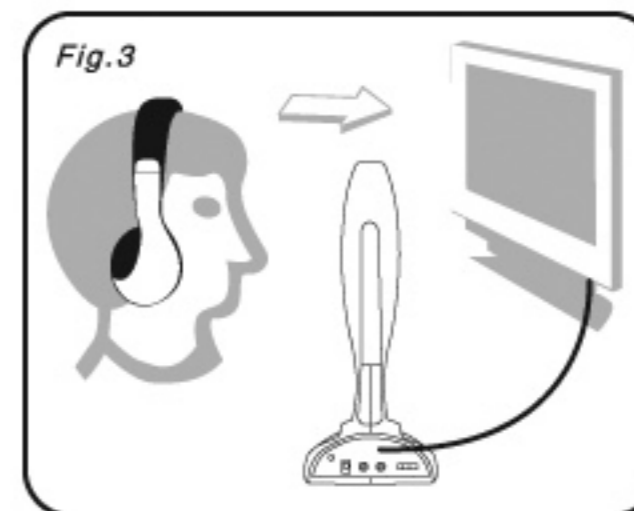
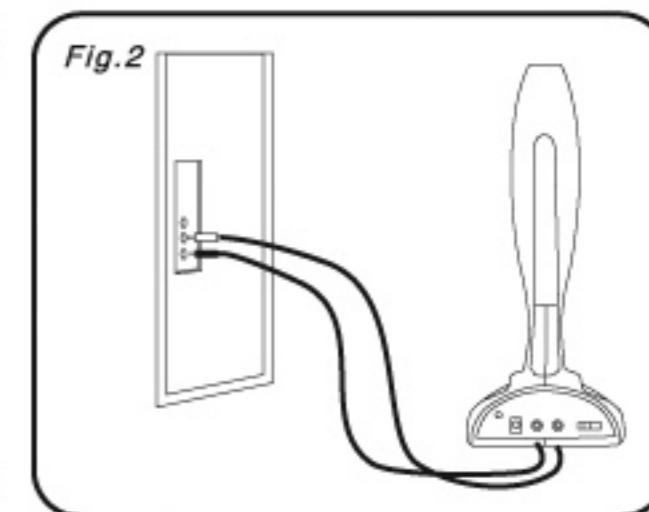
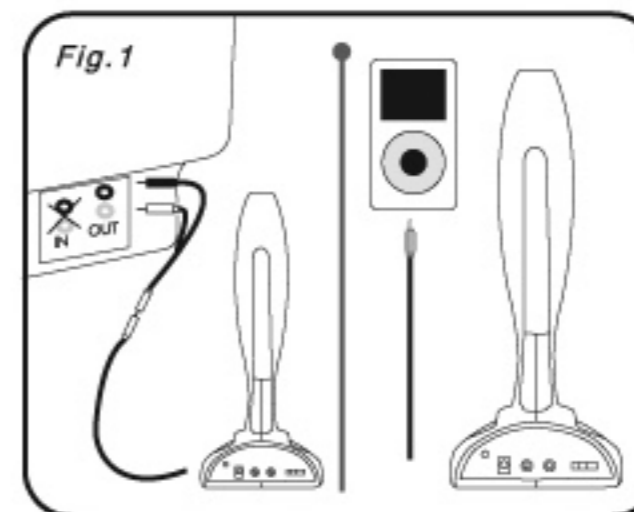

Other Connections

- **Using your wireless headphones/ Radio**

- **Turning on**

Turn the volume wheel till it ends to be on.

- **Turning off**

Turn the transmitter to OFF, and turn the volume control receiver to the OFF. Power indicator receiver will be off. Remove batteries when it is not in use for a long time.

- **Radio**

The receiver/headphone can be used separately as an FM radio. Press SCAN key once, and the receiver will automatically search toward a higher range and lock one radio channel; when the highest range is reached, press RESET key, and the frequency returns to the lowest range. Press SCAN key again, and the receiver will search the radio channels from the low range again. Continually press the SCAN button to search for different FM radio stations.

Note: The transmitter is not required when radio mode is in use.

- **Charging function**

Please noted: Please do not put battery in when the transmitter is in Charging.

You can charge the transmitter by connect the adapter cable to the power socket when turn off the transmitter at the same time.

- **Wired headphone**

Simply connect the headphone with the 3.5mm cable to the device such as computer, laptop, phones, tablets, MP3 player, CD/DVD player, etc.

Troubleshooting

- **I connected the wireless transmitter to a stereo, MP3 player or computer but do not hear anything.**

Check the Volume/Power is in the "on". Check the AUDIO CABLE is connecting the transmitter and the music device. Put the headset on, press the RESET key, and press SCAN, the sound sent from transmitter should be heard.

Try adjusting the volume.

Replace the batteries.

- **I connected the wireless transmitter to a television but do not hear anything on the headset.**

If you are receiving cable or satellite service, make sure that the AUDIO CABLE is connected to the cable or satellite box and NOT the television.

Check that the POWER indicator is in on., and the headset is power ON.

Put the headset on, press the RESET key, and press SCAN, the sound sent from transmitter should be heard.

Try adjusting the volume.

Replace the batteries.

- **The sound quality is poor.**

You may be out of range, try moving closer to the wireless transmitter.

Press the RESET and SCAN buttons to acquire a better frequency.

- **The FM radio does not work.**

Put the headset on, press the RESET key, and press SCAN, the sound sent from transmitter should be heard.

Continually press the SCAN button to search for different FM radio stations.

Radio reception may varies depends on the range of radio tower.

Specification

Transmitter

Frequency: 86± 0.5 MHz

Modulation mode: FM

Emission distance: over 100 ft

Power supply: 2 x AAA or 4.5V DC

Receiver

Frequency range: 84 - 108 MHz

Reception mode: FM

Distortion: ?2%

Power Supply: 2 x AAA

Limited Warranty

Kinyo Company Inc. (KINYO) warrants this product to the original purchase against defects in material and workmanship for a period of one (1) year from the date of purchase. Kinyo will, at its option, repair or replace the defective product at no cost to you during the warranty period.

The warranty will not apply if the unit has been subject to accident, misuse, abuse, disassembly, altered or operated contrary to the instructions contained in the accompanying manual.

To obtain warranty service, proof of purchase, in the form of retail receipt, bill of sale or invoice must be presented as evidence that the unit is within the warranty period. The product must be packaged either in its original package or in such a way as to reasonably protect it from shipping damage. Properly fill out the warranty card with description of problem. Send the product freight prepaid or deliver to:

**ATTN: SERVICE DEPT. KINYO COMPANY INC.
14235 LOMITAS AVE., LA PUENTE, CA 91746**

ONE YEAR LIMITED WARRANTY CERTIFICATE

NAME _____
ADDRESS _____
CITY _____ STATE _____ ZIP _____
PHONE _____ EMAIL _____ MODEL# _____
DATE OF PURCHASE _____ WHERE PURCHASED _____
PROBLEM _____
SIGNATURE _____ DATE _____

**This warranty is only valid in the United States of America.*